

Recommended PCB Layout
 Solder Area

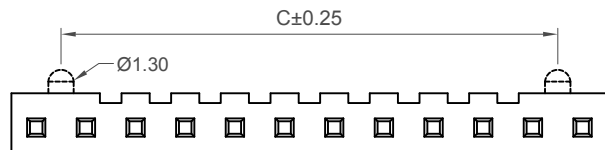

Ordering Grid

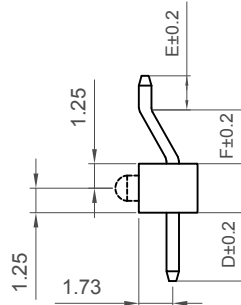
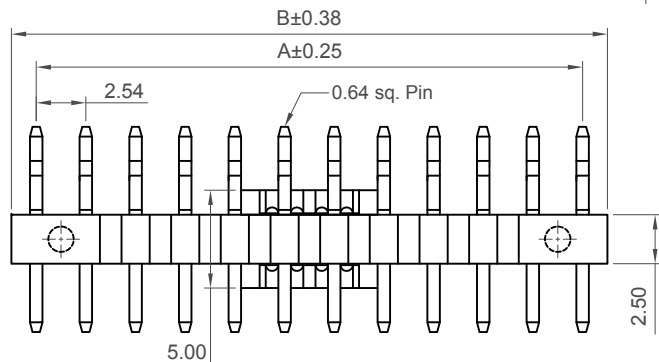
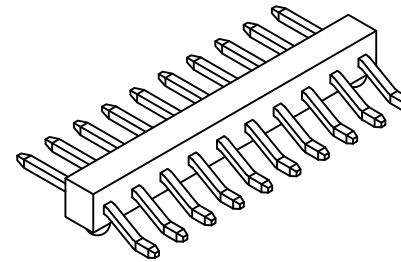
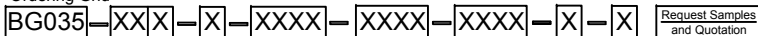

No. of Contacts
03 to 30

Contact Plating

A = Gold Flash All Over (Standard)
 B = Selective Gold Flash Contact Area/
 Tin On Tail
 C = Tin All Over
 G = 10µ" Gold Contact Area/Tin On Tail
 I = 30µ" Gold Contact Area/Tin On Tail

Locating Peg

0 = No Peg
 1 = With Peg

Dimension D (1/100mm) (Post Length)

0320 = 3.20mm (Standard)
 Or specify Dimension D
 eg 0250 = 2.50mm
 (Maximum 1200 = 12.00mm)
 (Minimum 0100 = 1.00mm)

Packing Options

B = Tape and Reel with Cap (Standard)
 A = Tape and Reel
 C = Tape and Reel with Film
 D = Tube
 E = Tube with Cap

Insulator Material

N = Nylon 6T (Standard)
 L = LCP

Dimension F (1/100mm) (Tail Bend Length)

0290 = 2.90mm (Standard)
 Or specify Dimension F
 eg 0250 = 2.50mm
 (Maximum 0500 = 5.00mm)
 (Minimum 0200 = 2.00mm)

Dimension E (1/100mm) (Tail Foot Length)

0180 = 1.80mm (Standard-Minimum)
 Or specify Dimension E
 eg 0250 = 2.50mm (Maximum)

Specifications

Material

Insulator:
 Standard: Polyamide, Nylon 6T, UL 94V-0
 Option: Polymer, LCP, UL 94V-0
 Contact Terminal: Copper Alloy

Plating

Contact Terminal: See ordering Grid

Electrical

Current Rating: 3 Amp Per Pin
 Contact Resistance: 20 mΩ max.
 Insulation Resistance: 1000 MΩ min.
 Dielectric Withstand Voltage: 600 V AC

Mechanical & Environmental

Operating Temperature: -40°C to +105°C

Soldering Process:

Nylon 6T (Standard) -
 IR Reflow: 260°C for 10 sec.
 Wave: 230°C for 5-10sec.
 Manual Solder: 350°C for 3-5sec.

LCP (Option) -

IR Reflow: 260°C for 10 sec.
 Wave: 250°C for 5-10sec.
 Manual Solder: 350°C for 3-5 sec.

Mates with (Subject to pin length):

BG090 BG095 BG096 BG100 BG110
 BG115 BG125 BG126 BG130 BG135
 BG145 BG205 BG230

Number of Contacts	Dimensions		
	A	B	C
3	5.08	7.62	2.54
4	7.62	10.16	5.08
5	10.16	12.70	7.62
6	12.70	15.24	10.16
7	15.24	17.78	12.70
8	17.78	20.32	15.24
9	20.32	22.86	17.78
10	22.86	25.40	20.32
11	25.40	27.94	22.86
12	27.94	30.48	25.40
13	30.48	33.02	27.94
14	33.02	35.56	30.48
15	35.56	38.10	33.02
16	38.10	40.64	35.56
17	40.64	43.18	38.10
18	43.18	45.72	40.64
19	45.72	48.26	43.18
20	48.26	50.80	45.72
21	50.80	53.34	48.26
22	53.34	55.88	50.80
23	55.88	58.42	53.34
24	58.42	60.96	55.88
25	60.96	63.50	58.42
26	63.50	66.04	60.96
27	66.04	68.58	63.50
28	68.58	71.12	66.04
29	71.12	73.66	68.58
30	73.66	76.20	71.12

Part Number BG035		Product Description 2.54mm Pitch Pin Header Single Row, Surface Mount, Horizontal	
Drawing Date		1st November 2006	
By	CC	Tolerances (Except as Noted)	Units: Metric (mm)
Detail	BG035 D PCN	Length X. ± 0.30 X.X ± 0.20 X.XX ± 0.15 X.XXX ± 0.10	Angle X° ± 5° X.X° ± 2° X.XX° ± 1° X.XXX° ± 0.5°
Revision	D4	3rd Angle Projection	
Date	17/04/20		



This drawing is confidential and copyright of Global Connector Technology, Ltd (GCT). This drawing must not be copied or disclosed without written consent. E & OE



Not to Scale	Drawn By LYH	Sheet No. 1/1
--------------	-----------------	------------------

H
G
F
E
D
C
B
A

1 2 3 4 5 6 7 8