

RECOMMENDED PCB LAYOUT

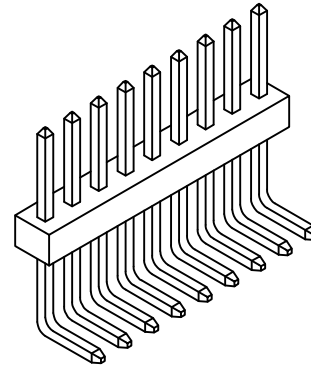
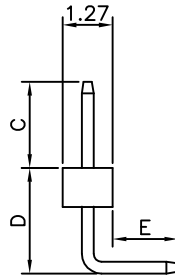
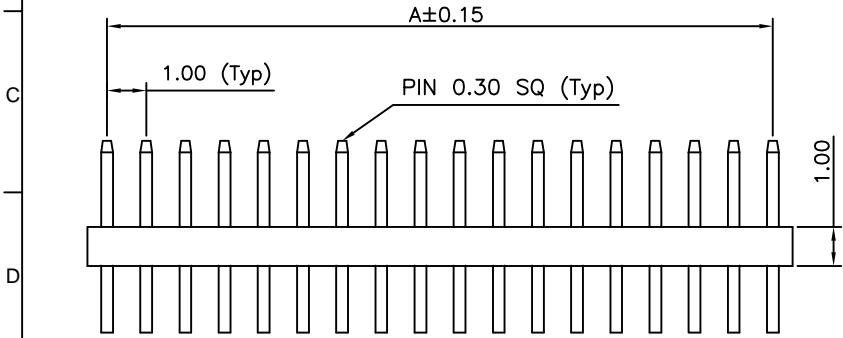

CONTACTS	DIMENSIONS	
	A	B
2	1.00	2.00
3	2.00	3.00
4	3.00	4.00
5	4.00	5.00
6	5.00	6.00
7	6.00	7.00
8	7.00	8.00
9	8.00	9.00
10	9.00	10.00
11	10.00	11.00
12	11.00	12.00
13	12.00	13.00
14	13.00	14.00
15	14.00	15.00
16	15.00	16.00
17	16.00	17.00
18	17.00	18.00
19	18.00	19.00
20	19.00	20.00
21	20.00	21.00
22	21.00	22.00
23	22.00	23.00
24	23.00	24.00
25	24.00	25.00
26	25.00	26.00
27	26.00	27.00
28	27.00	28.00
29	28.00	29.00
30	29.00	30.00
31	30.00	31.00
32	31.00	32.00
33	32.00	33.00
34	33.00	34.00
35	34.00	35.00
36	35.00	36.00
37	36.00	37.00
38	37.00	38.00
39	38.00	39.00
40	39.00	40.00

Ordering Grid: BC030-XX-X-XXXX-XXXX-XXXX-L-X

No. of Contacts: 02 to 40
 Contact Plating: A = Gold Flash All Over, C = Tin All Over
Standard = Gold Flash All Over



Dimension C (1/100mm) (Post Height)
Standard - 2.00mm = 0200
 or specify Dimension C
 e.g. 2.50mm = 0250
 Tol +/- 0.2mm

Dimension D (1/100mm) (Top of Insulator to Pin Bend)
Standard - 1.40mm = 0140
 or specify Dimension D
 e.g. 2.50mm = 0250
 Tol +/- 0.2mm

Dimension E (1/100mm) (Tail Length)
Standard - 2.50mm = 0250
 or specify Dimension E
 e.g. 4.50mm = 0450
 Tol +/- 0.2mm

REQUEST SAMPLES AND QUOTATION

Packing Options:
 G = Plastic Box (Standard)
 D = Tube
 E = Tube with Cap
 Insulator Material:
 L = LCP (Standard)

SPECIFICATIONS 规格:

CURRENT RATING 电流额定值: 1 AMP
 INSULATOR RESISTANCE 绝缘电阻值: 1000 MEGOHMS MIN.
 DIELECTRIC WITHSTANDING 耐电压: AC 300 V
 CONTACT RESISTANCE 接触电阻值: 20mΩ Max.
 OPERATING TEMPERATURE 工作温度: -40°C TO +105°C
 CONTACT MATERIAL 端子物料: COPPER ALLOY
 INSULATOR MATERIAL 绝缘体物料:
 STANDARD 标准物料: POLYESTER 聚酯, LCP, UL 94-V0
 SOLDERING PROCESS 可焊性:
 LCP (STANDARD 标准物料) -
 IR REFLOW 回流焊: 260°C for 10 sec.
 WAVE 波峰焊: 250°C for 5-10 sec
 MANUAL SOLDER 人工焊接: 350°C for 3-5 sec

MATES WITH 配套之母座 (SUBJECT TO PIN LENGTH 在端子长度适合的条件下):

BC065 BC070 BC075

By	ASE	GG	SA
DETAIL	DRAWING RELEASE	CHANGE TO SOLDER TEMP. INFORMATION	AMENDMENT TO PLATING OPTIONS
REV DATE	A 20/05/08	B 23/07/09	C 21/12/09



Tolerances (Except as noted)	Part Number:-	Date:-
Dimensions in mm	BC030	20 MAY 08
X. ± 0.30 X.° ± 5°	Description:-	
X.X ± 0.25 X.° ± 3°	1.0mm PITCH PIN HEADER, SINGLE ROW, THROUGH HOLE, HORIZONTAL	
X.XX ± 0.15 XX° ± 2°		
X.XXX ± 0.10 XXX° ± 1°		
Third Angle Projection	© THIS DRAWING IS CONFIDENTIAL AND MUST NOT BE COPIED OR DISCLOSED WITHOUT WRITTEN CONSENT	

Scale NTS	Revision C	Material See Note	Drawn by ASE	Sheet No. E & OE 1/1
-----------	------------	-------------------	--------------	----------------------

GCT

www.globalconnectortechology.com