

RECOMMENDED PCB LAYOUT

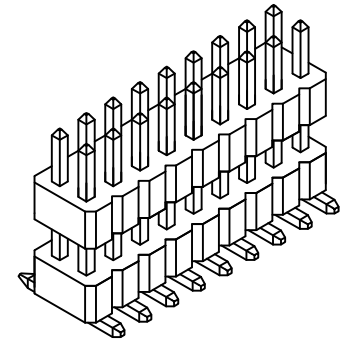
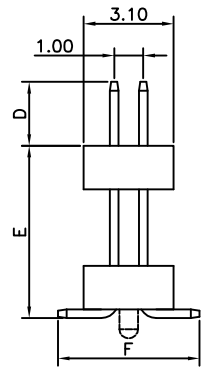

CONTACTS	DIMENSIONS		
	A	B	C
6	2.00	3.20	1.00
8	3.00	4.20	2.00
10	4.00	5.20	3.00
12	5.00	6.20	4.00
14	6.00	7.20	5.00
16	7.00	8.20	6.00
18	8.00	9.20	7.00
20	9.00	10.20	8.00
22	10.00	11.20	9.00
24	11.00	12.20	10.00
26	12.00	13.20	11.00
28	13.00	14.20	12.00
30	14.00	15.20	13.00
32	15.00	16.20	14.00
34	16.00	17.20	15.00
36	17.00	18.20	16.00
38	18.00	19.20	17.00
40	19.00	20.20	18.00
42	20.00	21.20	19.00
44	21.00	22.20	20.00
46	22.00	23.20	21.00
48	23.00	24.20	22.00
50	24.00	25.20	23.00
52	25.00	26.20	24.00
54	26.00	27.20	25.00
56	27.00	28.20	26.00
58	28.00	29.20	27.00
60	29.00	30.20	28.00
62	30.00	31.20	29.00
64	31.00	32.20	30.00
66	32.00	33.20	31.00
68	33.00	34.20	32.00
70	34.00	35.20	33.00
72	35.00	36.20	34.00
74	36.00	37.20	35.00
76	37.00	38.20	36.00
78	38.00	39.20	37.00
80	39.00	40.20	38.00

SPECIFICATIONS 规格:

CURRENT RATING 电流额定值: 1 AMP
 INSULATOR RESISTANCE 绝缘电阻值: 1000 MEGOHMS MIN.
 DIELECTRIC WITHSTANDING 耐电压: AC 300 V
 CONTACT RESISTANCE 接触电阻值: 20mΩ Max.
 OPERATING TEMPERATURE 工作温度: -40°C TO +105°C
 CONTACT MATERIAL 端子物料: COPPER ALLOY
 INSULATOR MATERIAL 绝缘体物料:
 STANDARD 标准物料: POLYESTER 聚酯, LCP, UL 94-V0
 SOLDERING PROCESS 可焊性:
 LCP (STANDARD 标准物料) -
 IR REFLOW 回流焊: 260°C for 10 sec.
 WAVE 波峰焊: 250°C for 5-10 sec
 MANUAL SOLDER 人工焊接: 350°C for 3-5 sec

Ordering Grid

BC055-XX-X-XXXX-XXXX-XXXX-LX

REQUEST SAMPLES AND QUOTATION

No. of Contacts: 06 to 80

Contact Plating: A = Gold Flash All Over, C = Tin All Over, Standard = Gold Flash All Over

Insulator Height 'H': K = 1.00mm, A = 1.50mm, Standard = 1.00mm

Locating Peg: 0 = No Peg, 1 = With Peg

Dimension D (1/100mm) (Post Height): Standard - 1.90mm = 0190, or specify Dimension D e.g. 2.50mm = 0250, Tol ± 0.2mm

Dimension E (1/100mm) (Stack Height): Standard - 2.30mm = 0230, or specify Dimension E e.g. 2.50mm = 0250, Tol ± 0.2mm

Dimension F (1/100mm) (Footprint Width): Standard - 5.20mm = 0520, or specify Dimension F e.g. 2.50mm = 0250, Tol ± 0.2mm

Packing Options: B = Tape and Reel with Cap (Standard), D = Tube (Standard-where total height exceeds 25mm), E = Tube with Cap

Insulator Material: L = LCP (Standard)

MATES WITH 配套之母座 (SUBJECT TO PIN LENGTH 在端子长度适合的条件下): BC084 BC085

By	AE	GG	AE	SA
DETAIL	DRAWING RELEASE	CHANGE TO SOLDER TEMP. INFORMATION	CHANGE TO PCB LAYOUT	AMENDMENT TO PLATING OPTIONS
REV DATE	A 20/05/08	B 23/07/09	C 28/08/09	D 21/12/09



Tolerances (Except as noted)	Part Number:- BC055	Date:- 20 MAY 08
Dimensions in mm	Description:-	
X. ± 0.30	1.0mm PITCH ELEVATED PIN HEADER, DUAL ROW, SURFACE MOUNT, HORIZONTAL	
X.X ± 0.25	© THIS DRAWING IS CONFIDENTIAL AND MUST NOT BE COPIED OR DISCLOSED WITHOUT WRITTEN CONSENT	
XXX ± 0.15	Scale NTS	
XXX ± 0.10	Revision D	
	Material See Note	
	Drawn by ASE	
	E & OE	
	Sheet No. 1/1	



www.globalconnectortech.com